

OVERHEAD DOOR CLOSERS 4000 SERIES

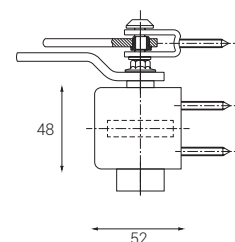

4900 E-slide

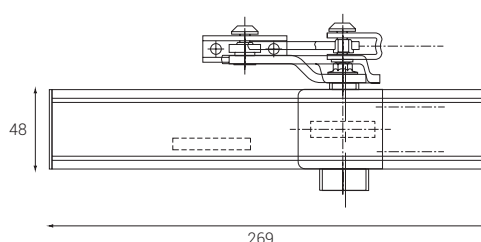

BS EN 1154

		4900	4930
Closing Force	EN Size	2-5	2-5
Door Size (Max)	Width (mm)	1250	1250
	Weight (kg)	100	100
Application	fig 1.	✓	✓
	fig 6.	✓	✓
	fig 66.	✓	✓
Mechanism	Cam & Roller	✓	✓
With Cover		✗	✗
Power Shoe Bracket		✓	✓
Angle of Opening		180	180
Non Handed		✓	✓
Power Adjustment	By Spring	✓	✓
Adjustable Sweep Speed		✓	✓
Adjustable Latching Speed		✓	✓
Adjustable Backcheck		✗	✓
Adjustable Delayed Action		✗	✗
CE Marked		✓	✓
Certifire Approved		✓	✓
Guarantee		10 yrs	10 yrs
Hold Open Arm		✓	✓

OVERHEAD DOOR CLOSERS WITH MATCHING ARM, AVAILABLE WITH A CHOICE OF 3 SLIDE COVERS

The 4000 overhead door closer range offers a choice of two closers, each available with the option of three different slides. Each closer offers the unique high-efficiency cam and roller action making them suitable for the Equality Act considerations. The main difference between the two models is the adjustable backcheck, which is available on the 4930 model but not the 4900.

Alternative closers are available if you have requirements outside of the specifications below.

All closers are supplied as standard with a matching arm, and there is also the option of having a hold open arm. All closers offer universal fitting and are supplied with brackets for fig 1, fig 61 and fig 66 fixing.

Finishes are available in: Silver, PAA, SAA, PB, SS, PS and all other RAL colours.

The main difference between the two models is the Adjustable Backcheck, which is available on the 4930 model but not the 4900

B-slide

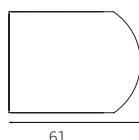

L-slide

